



*Sports*

## GYMNASIUM WALL PADS



\*Photo courtesy of BSN Sports and the Glenburn Panthers

### MEASURING & SUBMITTAL INSTRUCTIONS FOR WALL PADS

#### How to Measure for Gymnasium Wall Pads

Gymnasium wall configurations are virtually limitless. However, with proper measurements these walls can have properly fitted pads, which in turn equals a professional appearance that is sure to enhance the look of any gymnasium.

Measuring the respective walls is a relatively easy project. Prior to starting, you'll need the following tools:

- Measuring tape. 100'+ in length is preferable.
- Camera phone.
- A pencil or pen to document the measurements.
- Printed photos of the wall/stage. If photos are not available, a hand drawing will help you keep things straight.

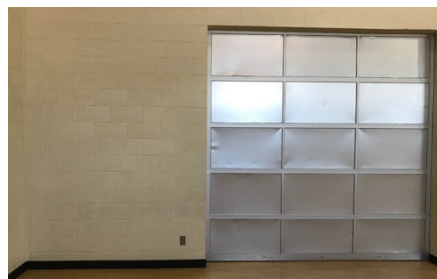

### Wall A

### Wall B

With your tools in hand and the step-by-step process below, you're ready to begin measuring.

1. If there are old pads on the wall, you can use these for reference, but it's best if the pads are removed for accurate measurements. A bare working space is best.
2. Your first measurement is the easiest measurement of the day- the height of the transition coping. The coping is the protective plastic/rubber between the gym floor and the wall. This is normally black in color and is approx. 4" to 6" tall. It's important to have this measured and documented so you can accurately measure for any wall cutouts- outlets, light switches, etc. This measurement needs to be from the gym floor to the coping's top. All of your height measurements will begin from the coping. If the coping is not present, the measurements will be from ground level.

With regards to the pad heights, most are pretty standard- 5', 6' or 7' tall.

3. As we read from left to right, it's best to start your measurements on the left side of the wall, and work to the right. For the most part, there will be little change. The changes occur when you run into an obstacle, like an outlet or a chin up bar, as seen below.

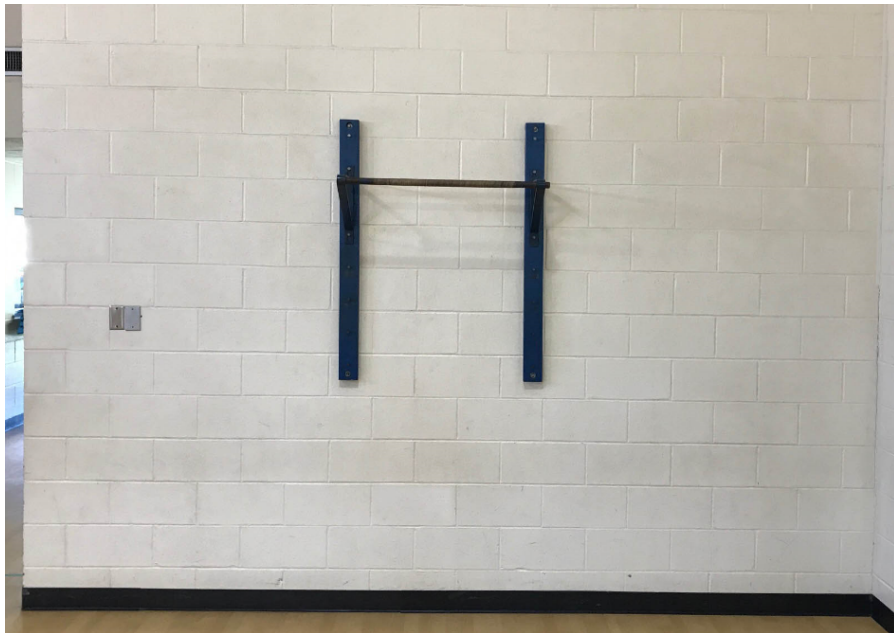

This next image shows you what to measure.

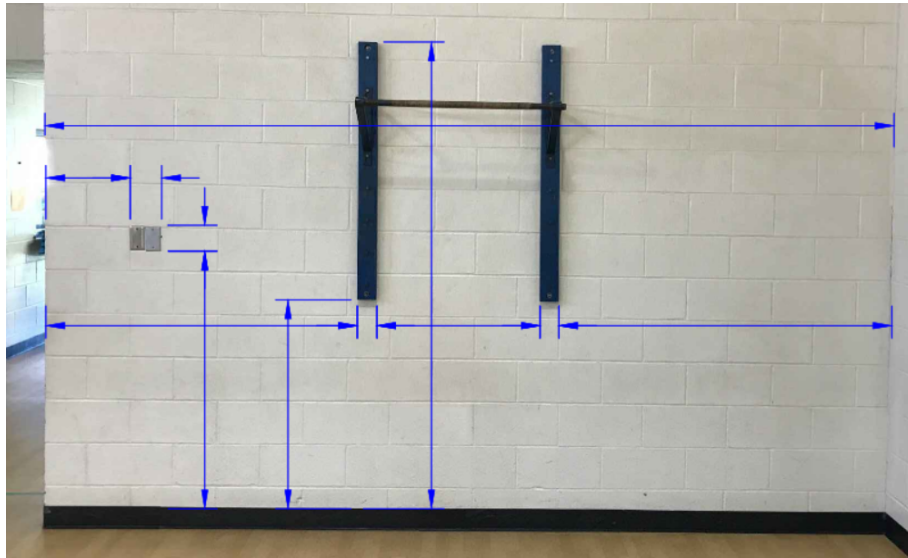

Each measurement is designed to help us give you the perfect fit. Your measurements need to be to the edge(s) of the obstacles. When our CAD department builds your drawings, the designer will allow a 3/4" measurement around the perimeter of the obstacles. This will allow a slight space between the pad's edge, and the start of the obstacle.

- To continue with the above illustration, the following CAD drawing is based on the supplied information and what would be sent to you for confirmation.

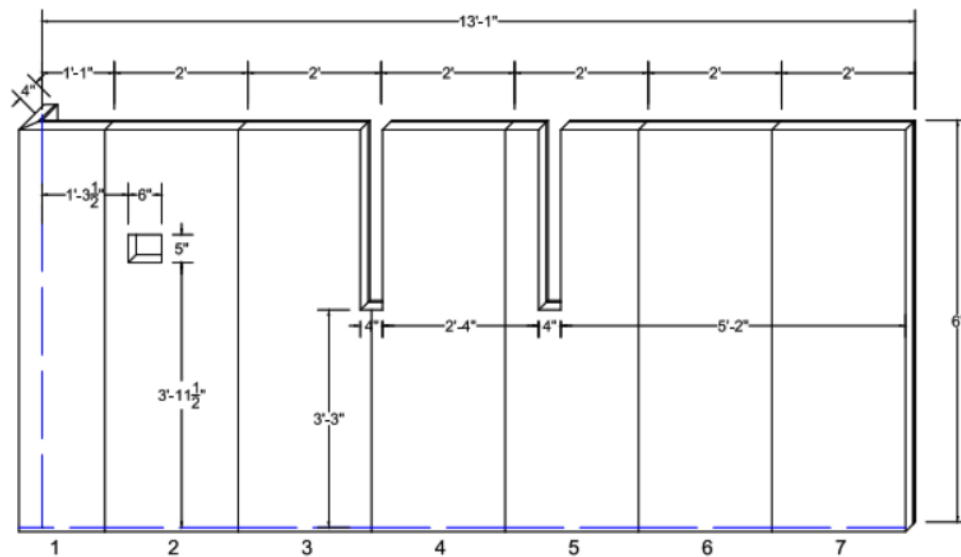

Note the left corner on the above drawing. You'll see that the pad is fitted around a corner. This is known as a return. A return covers a wall's corner. The measurement on the opposite side of the wall is normally less than a foot. However, it's based on what coverage the end-user is requesting.

- You'll repeat the measuring process for each of the remaining walls as illustrated below.



A CAD drawing like the one below will be returned to you.

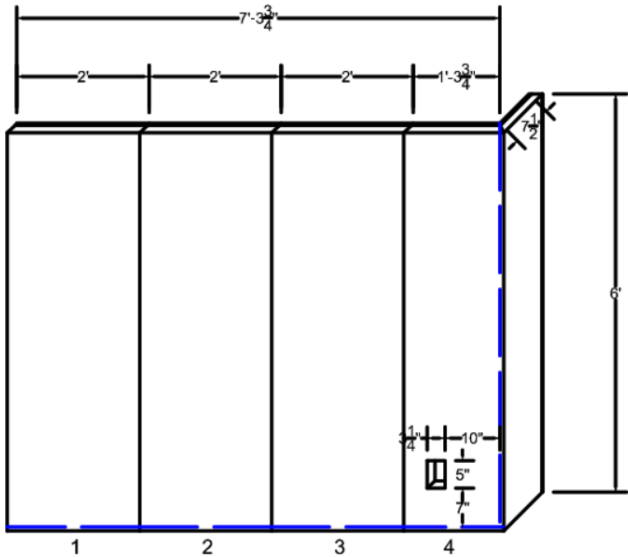

- 6. As mentioned above, once the photos/drawings and measurements have been submitted, a quote and CAD drawing(s) will be sent back on a sign-off form, shown below.

<b>AER-FLO</b>	<b>MEASUREMENT APPROVAL</b>	DATE: 08-07-2020 DESIGNER: ANNISTON QUOTE #:	CUSTOMER: PO#: SO#:
<b>WALL A</b>			
TYPE OF PRODUCT: WALL PADS COLOR: ROYAL BLUE TYPE OF FABRIC: 19 oz FR VINYL NUMBER OF PIECES: 7 NUMBER OF CUTOUTS: 4 FOAM THICKNESS: 2" FOAM TYPE OF BACKING: 7/16" OSB BOARD COMMENTS:	<b>CUSTOMER APPROVAL (BOXES CHECKED, SIGNED, AND DATED) PRIOR TO PRODUCTION</b> <input type="checkbox"/> PRODUCT TYPE/COLOR IS CORRECT <input type="checkbox"/> LAYOUT IS CORRECT AND PROPERLY COVERS ALL DESIRED PADDING <input type="checkbox"/> DIMENSIONS ARE CORRECT <input type="checkbox"/> AER-FLO TRIES TO BE AS ACCURATE AS POSSIBLE, BUT CUSTOMER HAS FINAL RESPONSIBILITY		
	SIGNATURE: _____ PRINT: _____ DATE: _____		
4435 18th Street East * Bradenton, FL 34203 * Toll Free (800) 823-7356 * fax (941)-747-2489 * customerservice@aerflo.com			

7. It's imperative that prior to signing these forms and submitting a PO, the drawings are taken back to the wall(s) and the dimensions are confirmed. Signing the forms and submitting them with a PO is confirmation that all desired padding and dimensions are accurate and no changes need to be made. In addition, you, the rep, are taking full accountability for any mistakes, including those made by Aer-Flo in creating the CAD drawing. In order for the sign-off form to be accepted, you must have the (4) boxes left of the signature line checked (✓), a signature, printed name and date. See below.

<b>CUSTOMER APPROVAL (BOXES CHECKED, SIGNED, AND DATED) PRIOR TO PRODUCTION</b>	
<input checked="" type="checkbox"/> PRODUCT TYPE/COLOR IS CORRECT <input checked="" type="checkbox"/> LAYOUT IS CORRECT AND PROPERLY COVERS ALL DESIRED PADDING <input checked="" type="checkbox"/> DIMENSIONS ARE CORRECT <input checked="" type="checkbox"/> AER-FLO TRIES TO BE AS ACCURATE AS POSSIBLE, BUT CUSTOMER HAS FINAL RESPONSIBILITY	SIGNATURE: <u>John Doe</u> PRINT: <u>JOHN DOE</u> DATE: <u>8/1/2020</u>

The PO will be issued based on the signed drawings and quote. Aer-Flo will then make the pads per the drawings. If changes need to be made, they need to be noted on the CAD drawings and emailed to your Aer-Flo rep or Customer Service. Verbal changes will not be accepted. Once the changes have been submitted to Customer Service, revised CAD drawings will be issued, and measurement confirmation will again need to be done on-site.

**REMEMBER... DON'T "GUESSTIMATE". WHEN IN DOUBT, ASK FOR HELP.  
IT'S BETTER FOR YOU TO MEASURE TWICE, BEFORE WE CUT ONCE.**





\*Photo courtesy of BSN Sports and Killian Hills Cougars

### **How to Properly Care for your Gymnasium Wall**

Maintenance of your pads is extremely important for the longevity of the pads. Why invest in a professional looking pad system and not take the steps to ensure that your pads keep that new, professional look for years to come? The following care steps are a couple things that will keep your pads looking fresh and clean.

1. Because these are indoor pads, simply wiping them periodically with water alone will keep your pads looking new.
2. Repair any cuts or tears promptly using Tear-Aid. Available through Aer-Flo or their dealer.



## GYMNASIUM STAGE PADS



\*Photo courtesy of BSN Sports and the Elsberry Indians

## MEASURING & SUBMITTAL INSTRUCTIONS FOR STAGE PADS

### How to Measure for Stage Pads

Like gymnasium wall, cafeteria or gym stages come in a number of configurations as well. Again, like gym walls, with proper measurements stage pads can enhance the look of any room with a stage.

Prior to starting, you'll need the following tools:

- Measuring tape. 100'+ in length is preferable.
- Camera phone.
- A pencil or pen to document the measurements.
- Printed photos of the wall/stage. If photos are not available, a hand drawing will help you keep things straight.



With your tools in hand and the step-by-step process below, you're ready to begin measuring.

1. If there are old pads on the stage, you can use these for reference, but it's best if the pads are removed for accurate measurements. A bare working space is best.
2. Your first measurement is the easiest measurement of the day- the height of the transition coping. The coping is the protective plastic/rubber between the floor and the stage's wall face. This is normally black in color and is approx. 4" to 6" tall. It's important to have this measured and documented so you can accurately measure for any wall cutouts- outlets, light switches, etc. This measurement needs to be from the floor to the coping's top. All of your height measurements will begin from the coping. If the coping is not present, the measurements will be from ground level.

With regards to the pad heights, stage heights vary so accurate measurements are a must.

3. As we read from left to right, it's best to start your measurements on the left side of the wall, and work to the right. For the most part, there will be little change. The changes occur when you run into an obstacle, like an outlet, as seen below.

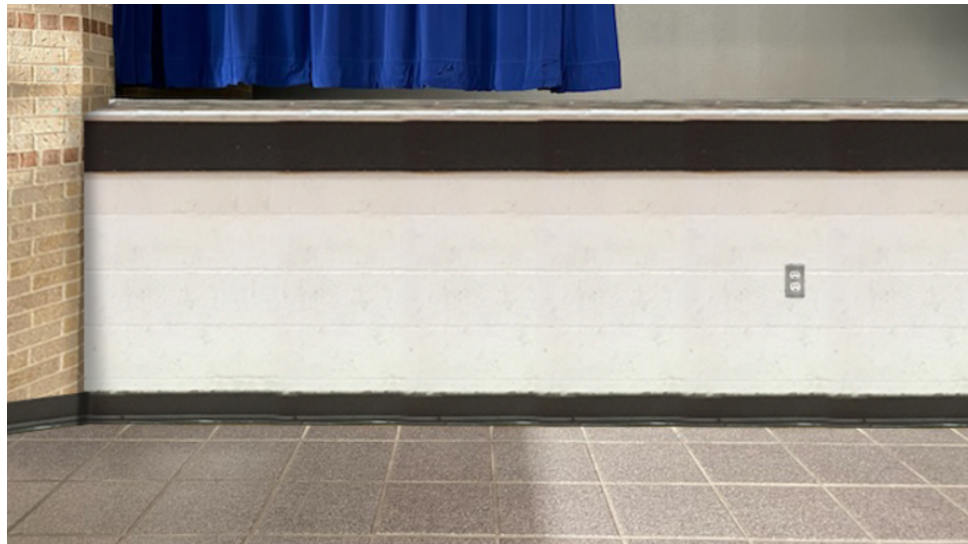

This next image shows you what to measure.



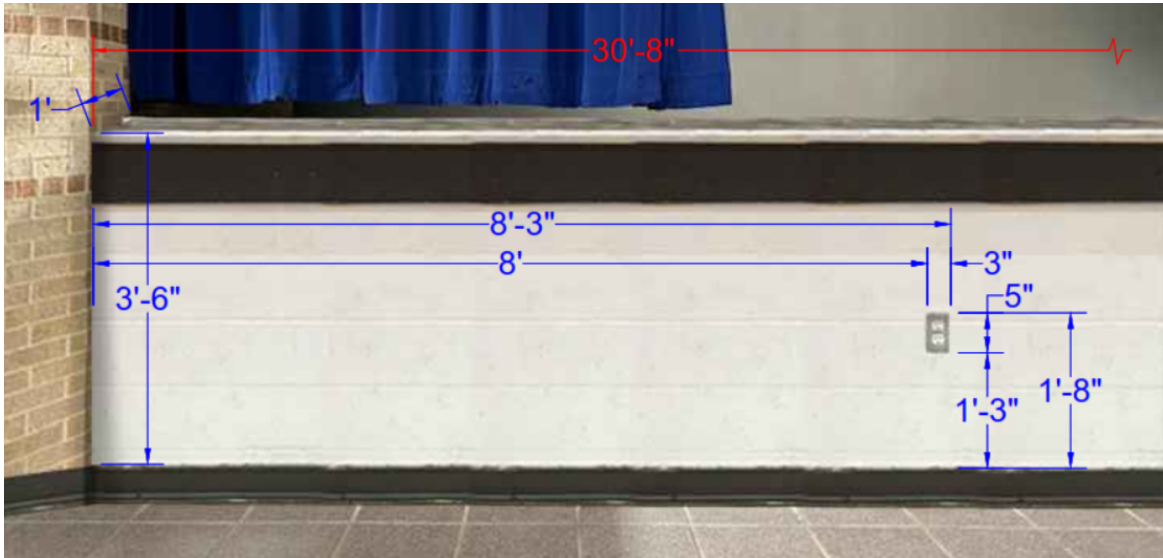

Each measurement is designed to help us give you the perfect fit. Your measurements need to be to the edge(s) of the obstacle(s). When our CAD department builds your drawings, the designer will allow a 3/4" measurement around the perimeter of the obstacles. This will allow a slight space between the pad's edge, and the start of the obstacle.

- To continue with the above illustration, the following CAD drawing is based on the supplied information and what would be sent to you for confirmation.

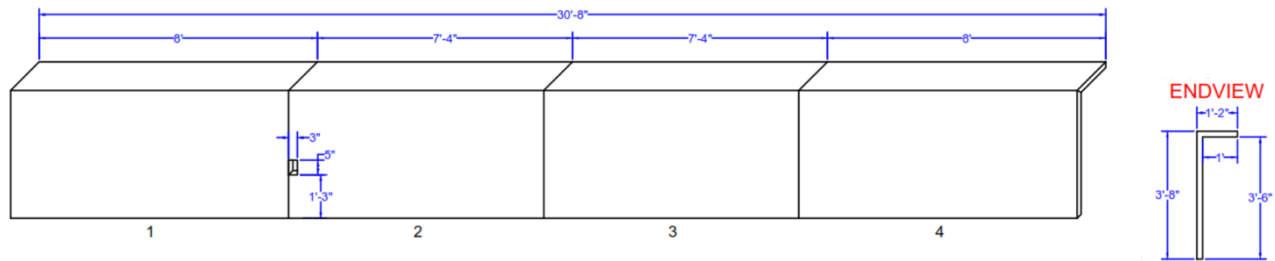

- As mentioned above, once the photos/drawings and measurements have been submitted, a quote and CAD drawing(s) will be sent back on a sign-off form, shown below.

<b>AER-FLO</b>	<b>MEASUREMENT APPROVAL</b>	DATE: 08-07-2020 DESIGNER: ANNISTON QUOTE #:	CUSTOMER: PO#: SO#:
TYPE OF PRODUCT: STAGE PADS COLOR: ROYAL BLUE TYPE OF FABRIC: 18 oz FR VINYL NUMBER OF PIECES: 4 NUMBER OF CUTOUTS: 1 FOAM THICKNESS: 2" FOAM TYPE OF ATTACHMENT: HOOK AND LOOP COMMENTS:	<b>CUSTOMER APPROVAL (BOXES CHECKED, SIGNED, AND DATED) PRIOR TO PRODUCTION</b> <input type="checkbox"/> PRODUCT TYPE/COLOR IS CORRECT <input type="checkbox"/> LAYOUT IS CORRECT AND PROPERLY COVERS ALL DESIRED PADDING <input type="checkbox"/> DIMENSIONS ARE CORRECT <input type="checkbox"/> AER-FLO TRIES TO BE AS ACCURATE AS POSSIBLE, BUT CUSTOMER HAS FINAL RESPONSIBILITY		
	SIGNATURE: _____ PRINT: _____ DATE: _____		
4455 18th Street East * Bradenton, FL 34203 * Toll Free (800) 823-7356 * fax (941)-747-2489 * customerservice@aerflo.com			

6. It's imperative that prior to signing these forms and submitting a PO, the drawings are taken back to the stage and the dimensions are confirmed. Signing the forms and submitting them with a PO is confirmation that all is accurate and no changes need to be made. In addition, you, the rep, are taking full accountability for any mistakes, including those made by Aer-Flo in creating the CAD drawing. In order for the sign-off form to be accepted, you must have the (4) boxes left of the signature line checked (✓), a signature, printed name and date. See below.

<b>CUSTOMER APPROVAL (BOXES CHECKED, SIGNED, AND DATED) PRIOR TO PRODUCTION</b>	
<input checked="" type="checkbox"/> PRODUCT TYPE/COLOR IS CORRECT <input checked="" type="checkbox"/> LAYOUT IS CORRECT AND PROPERLY COVERS ALL DESIRED PADDING <input checked="" type="checkbox"/> DIMENSIONS ARE CORRECT <input checked="" type="checkbox"/> AER-FLO TRIES TO BE AS ACCURATE AS POSSIBLE, BUT CUSTOMER HAS FINAL RESPONSIBILITY	SIGNATURE: <u>John Doe</u> PRINT: <u>JOHN DOE</u> DATE: <u>8/1/2020</u>

The PO will be issued based on the signed drawings and quote. Aer-Flo will then make the pads per the drawings. If changes need to be made, they need to be noted on the CAD drawings and emailed to your Aer-Flo rep or Customer Service. Verbal changes will not be accepted. Once the changes have been submitted to Customer Service, revised CAD drawings will be issued, and measurement confirmation will again need to be done on-site.

**REMEMBER... DON'T "GUESSTIMATE". WHEN IN DOUBT, ASK FOR HELP.  
IT'S BETTER FOR YOU TO MEASURE TWICE, BEFORE WE CUT ONCE.**



### How to Properly Care for your Stage Pads

Maintenance of your pads is extremely important for the longevity of the pads. Why invest in a professional looking pad system and not take the steps to ensure that your pads keep that new, professional look for years to come? The following care steps are a couple things that will keep your pads looking fresh and clean.

1. Because these are indoor pads, simply wiping them periodically with water alone will keep your pads looking new.
2. Repair any cuts or tears promptly using Tear-Aid. Available through Aer-Flo or their dealer.

## GYMNASIUM WALL & STAGE PAD SPECIFICATIONS SHEET

### Standard Fabrication & Construction-

*Wood-Backing for gym wall pads:* Standard wood backing consists of 7/16" Oriented Strand Board (OSB).

*Vinyl Covering:* 18oz./sq. yd. fully coated Fire Rated vinyl.

*Scrim:* 1000d x 1300D polyester

*Tongue Tear Strength (FS-191-5134):* 100 lbs. x 100 lbs.

*Grab Tensile Strength (FS-191-5100):* 410 lbs. x 410 lbs.

*Weft Insertion:* 18 x 17

*Cold Crack (FS-191-5874):* -40 degrees F

*UV Resistance (Weather-O-Meter):* No excessive fading after 300 hours

*Thread (where needed):* High heat bonded polyester with UV inhibitors built into yarn.

*Available Colors:*

<b>BLACK</b>	<b>WHITE</b>	<b>VEGAS GOLD</b>	<b>ORANGE</b>	<b>BEIGE/TAN</b>	<b>YELLOW/GOLD</b>	<b>KELLY GREEN</b>	<b>MEDIUM GREEN</b>
<b>SPORTS GREY/CHARCOAL</b>	<b>GREY</b>	<b>CC SKY BLUE</b>	<b>NAVY BLUE</b>	<b>ROYAL BLUE</b>	<b>PURPLE</b>	<b>MAROON</b>	<b>RED</b>

*Imprinting Available:* Chroma-Bond® Digital Imprinting with SpotLight® Clear-Coat Finish

*Filler Foam:*

- Gym Wall Pads- 3 options
  - 2" & 3" thick poly urethane foam
  - 1-3/8" thick crosslink polyethylene foam

*Adhesive:* Synthetic resin based. Demonstrating high flexibility, excellent water and heat/cold resistance and superior bonding factor.

*Warranty:* 1-Year Prorated Warranty (following page)

Also available upon request:

- Full Fire Retardant Pads: These pads include a fire rating for all three components of the pads- vinyl, foam and wood.
- Wood-Backed Stage Pads.
- 3/4" plywood backing for pads.

## **GYMNASIUM WALL & STAGE PAD WARRANTY**

AER-FLO, INC. (Aer-Flo) warrants its gymnasium wall & stage pads to be free of defects in materials and workmanship under normal use and service for a period of 1 year.

Units determined by Aer-Flo to be defective under this warranty shall be replaced for a replacement cost calculated by the following formula:

The number of months since the original shipment date is divided by the number of months within the pad warranty (i.e. 1 year warranty = 12 months); the result is multiplied by the then current suggested resale price for the unit. The replacement cost does not include the cost of shipping and any taxes.

Warranty claims must be submitted directly to Aer-Flo and include photos that clearly show the area(s) of claimed failure. Aer-Flo may require all or part of the unit to be returned for testing.

REPLACEMENT IS THE ONLY REMEDY AVAILABLE UNDER THIS WARRANTY. The replacement unit carries no further expressed or implied warranty.

Specifically excluded from this warranty are (1) labor and installation and (2) imprinting and (3) damage due to any act of Mother Nature and (4) damage to negligent or abusive use or normal wear and tear, including, but not limited to, those items on Schedule A (following). Negligent, abusive, and other improper use of windscreen unit voids this warranty.

IN NO EVENT SHALL AER-FLO BE LIABLE FOR INCIDENTAL OR CONSEQUENTIAL DAMAGES, FOR LOSS OF PRODUCT OR TIME, OR FOR ANY DELAY IN PERFORMANCE UNDER THIS WARRANTY. AER-FLO MAKES NO OTHER WARRANTY, EXPRESSED OR IMPLIED, INCLUDING ANY WARRANTY OF MERCHANTABILITY. THIS WARRANTY SUPERCEDES AND/OR REPLACES ANY PRIOR WARRANTIES, IF ANY, ON SAME PRODUCTS.

The validity, construction and enforcement of, and the remedies under, this limited warranty shall be governed by the laws of the State of Florida. Jurisdiction and venue shall properly lie exclusively in the Twelfth Judicial Court of the State of



Florida, in and for Manatee County, Florida, or in the United States District Circuit Court for the Middle District of Florida, with respect to any legal proceedings arising from this limited, prorated warranty or use of the unit.

> Written claim plus photos and/or specimens should be sent to: Aer-Flo, Inc. • 4455 18<sup>th</sup> St. East • Bradenton, FL 35203  
> Digital claim and photos should be e-mailed to: [customerservice@aerflo.com](mailto:customerservice@aerflo.com)

#### SCHEDULE A

Following are descriptions of typical situations where this warranty does not apply. Exclusion is not limited to these situations.

EXAMPLES OF NORMAL WEAR AND TEAR: Accumulation of dirt or other substances on surface; Normal discoloration due to atmospheric exposure; Deterioration of surface imprinting.

EXAMPLES OF NEGLIGENT OR ABUSIVE USE: Cuts, punctures, abrasions, or scores; Threads cut, stretched, or burst; Burns, scorches, melted areas; Damage from exposure to excessive heat; Improper handling, such as dragging over damaging materials; Damage from improper attachment to rails or using improper attachment devices; Exposure to chemicals such as solvents, petrochemicals, paints, acids, alkaline materials, or other substances which damage vinyl.

Updated 8/2020